

Instruction Manual

Thank you for purchasing this product.
Before using this product please read the instructions carefully.

※Make sure that your Nintendo Switch is updated to the latest system firmware.

※This product does not support the following features.
・ Motion IR Camera ・ HD Rumble ・ NFC

※Wireless Connection ONLY (Not compatible when wired).

Warning

⚠ Caution To Parent/Guardian, Please read carefully

- This product contains small parts. Keep it away from children under 3 years old.
- Do not apply strong impact on this product.
- If the product needs cleaning, use only a soft dry cloth. Do not use any chemical agents like benzene or thinner.

How to Connect ※Cannot be paired using a USB cable

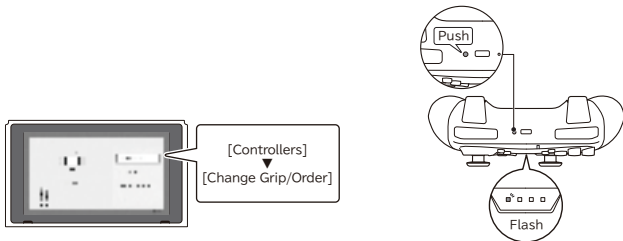

1. Select [Controllers]→ [Change Grip/Order]
from the HOME Menu.

2. Press and hold Sync Button for
at least two seconds.
*Controller will now pair to this
Nintendo Switch console
automatically.



- ・ Connect the controller to the Nintendo Switch Dock via USB connection to charge if the battery level is low.
- ・ Cannot be paired using a USB cable.
- ・ Press any button to use the product (except for L stick, L stick button, R stick, R stick button)
- ・ Must be paired to each Nintendo Switch separately.
- ・ Not compatible with the Nintendo Switch "Find Controllers" feature.
- ・ Do not touch the L Stick or R Stick while pairing or re-connecting.

Included

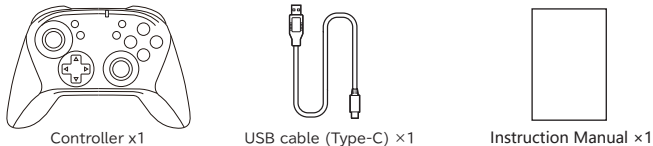

Platform

Nintendo Switch

※Not PC compatible

Layout

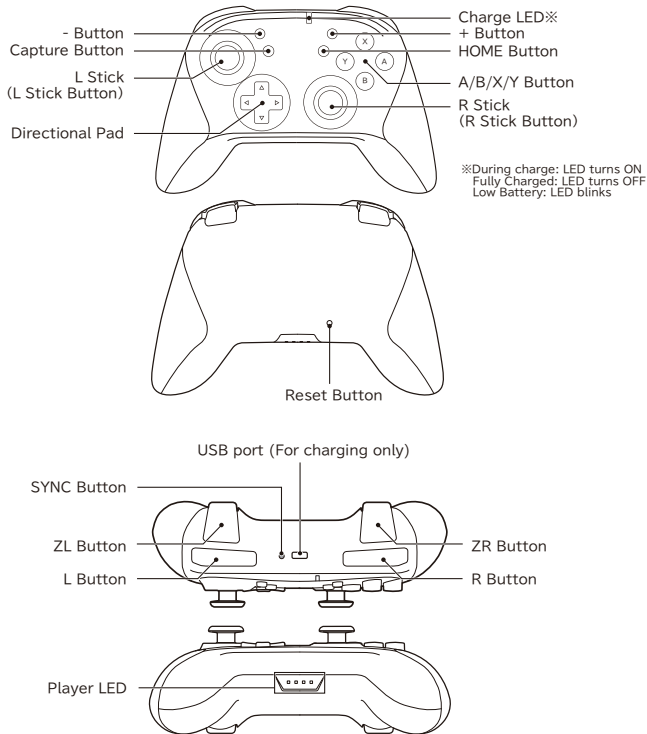

How to Charge

1. Connect the Nintendo Switch AC Adapter to the Nintendo Switch Dock.
2. Connect Wireless Pad to Nintendo Switch Dock via USB cable (Type-C).

Can also be charged while:

- ・ Nintendo Switch is not connected to the dock.
- ・ Nintendo Switch is in sleep mode or turned off.

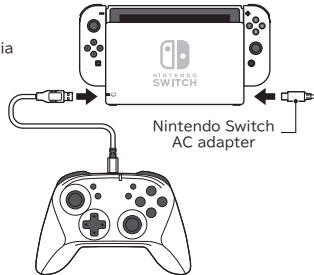

Troubleshooting

- ・ Controller does not respond.
→The battery may be low. Charge the controller accordingly.
- ・ Controller cannot be charged or does not respond on a full charge or reacts on its own.
→Use a thin object to press the reset button on the bottom of the controller to reset and reconnect the controller. If problem still persists, please contact HORI customer support.

※L/R stick, Accelerometer, Gyro Sensor cannot be adjusted.

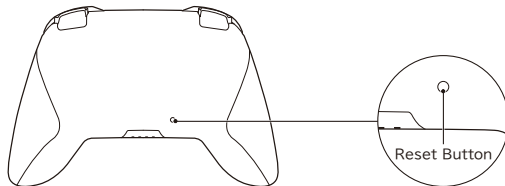

Specification

Size : (W) 6.4in (162mm) x (D) 2.3in (58mm) x (H) 4.3in (108mm)
Weight : 6oz (170g)
Sensor : Accelerometer / Gyro Sensor
Connection method: Bluetooth®5.0

Regarding Wireless Interference

This product uses a 2.4 GHz frequency band.
Other wireless devices may use the same frequency band.
To prevent radio interference with other wireless devices.
1. Please confirm that no other wireless devices are being used nearby.
2. In the unlikely event that radio interference occurs between this product and other wireless devices, change the area this product is used or turn the other wireless device off.

Regarding Battery

If batteries leak, please do not touch the acid with your bare hands.
Do not place this product near heat sources or leave under direct sunlight.
Internal battery life may deplete over the time.
Recharge the battery at least once a year to maintain function even if it has not been used for a prolonged time.



Lithium Polimer battery is recyclable resources.

The normal function of the product may be disturbed by strong electro-magnetic interference. If so, simply reset the product to resume normal operation by following the instruction manual (How to connect). In case the function does not resume, please relocate to an area which does not have electro-magnetic interference to use the product.

PRODUCT DISPOSAL INFORMATION

Where you see this symbol on any of our electrical products or packaging, it indicates that the relevant electrical product or battery should not be disposed of as general household waste in Europe. To ensure the correct waste treatment of the product and battery, please dispose of them in accordance with any applicable local laws or requirements for disposal of electrical equipment or batteries. In so doing, you will help to conserve natural resources and improve standards of environmental protection in treatment and disposal of electrical waste. Applicable to EU countries only.



THE FCC WANTS YOU TO KNOW

This device complies with part 15 of the FCC Rules. Operation is subject to the following two conditions: (1) This device may not cause harmful interference, and (2) this device must accept any interference received, including interference that may cause undesired operation.

NOTE: This equipment has been tested and found to comply with the limits for a Class B digital device, pursuant to part 15 of the FCC Rules. These limits are designed to provide reasonable protection against harmful interference in a residential installation. This equipment generates, uses and can radiate radio frequency energy and, if not installed and used in accordance with the instructions, may cause harmful interference to radio communications. However, there is no guarantee that interference will not occur in a particular installation. If this equipment does cause harmful interference to radio or television reception, which can be determined by turning the equipment off and on, the user is encouraged to try to correct the interference by one or more of the following measures:
—Reorient or relocate the receiving antenna.
—Increase the separation between the equipment and receiver.
—Connect the equipment into an outlet on a circuit different from that to which the receiver is connected.
—Consult the dealer or an experienced radio/TV technician for help.

US

Warranty

HORI warrants to the original purchaser that the product purchased new in its original packaging shall be free of any defects in material and workmanship for a period of 90 days from the original date of purchase. If the warranty claim cannot be processed through the original retailer please address directly to HORI at infous@hori.jp. Please visit <http://stores.horiusa.com/policies/> for warranty details.

EU

Warranty

For all warranty claims made within the first 30 days after purchase, please check with the retailer where the original purchase was made for details. If the warranty claim cannot be processed through the original retailer or for any other inquiries pertaining to our products, please address directly to HORI at infoue@hori.jp.

To contact AIC, the official representative of HORI in KSA, please contact us via email or phone.

Email: info@aic.com.sa

Phone number: 8001010029

For more details, you may visit HORI in KSA website: hori.aic.com.sa

Please retain contact information for future reference.

The image on the package may differ from the actual product.

The manufacturer reserves the right to change the product design or specifications without notice.

The wires are not to be inserted into socket-outlets.

The packaging must be retained since it contains important information.

HORI & HORI logo are registered trademarks of HORI.