

Instruction manual

Thank you for purchasing this product.
Before using this product please read the instructions carefully.
After reading the instruction manual, please keep it for reference.

Table of Contents

How to Connect	2
Included	2
Platform	2
Layout	3
How to Mount	4
Control Toggle Switch	4
Button Hold function	4
Assign Mode	5
Quick Handling Mode	6
Adjustable Sensitivity	6
Adjustable Dead Zone	7
Reset back to default settings	8
Caution	8
Main Specifications	8

■ How to Connect

- Make sure that direction of modular plug is correct before connecting.
- This product can be used without the foot pedals.

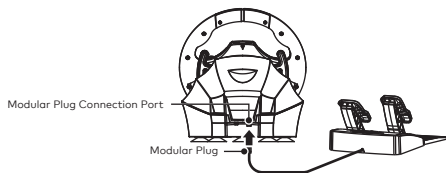

* This product is not a wireless controller.

Turn the steering wheel to its maximum rotation position once in both directions.
Press down fully into each of the L pedal and R pedal once.

- Please repeat the process when you re-connect the controller or restart the Nintendo Switch™ or PC system.

■ Included



Steering Unit



Foot Pedals



Suction Cups



Clamp



Screw



Instruction
Manual

■ Platform

Nintendo Switch™ / PC (Xinput)

* Functions as PC controller through Xinput.
This product does not support DirectInput.

Supported OS	Windows®10 / 8 ~ 8.1 / 7
System requirements	USB Port, Internet Connection

Important

Make sure that your Nintendo Switch™ is updated with the latest system software.

May not function for titles that require motion control.

Layout

Steering Unit (Front View)

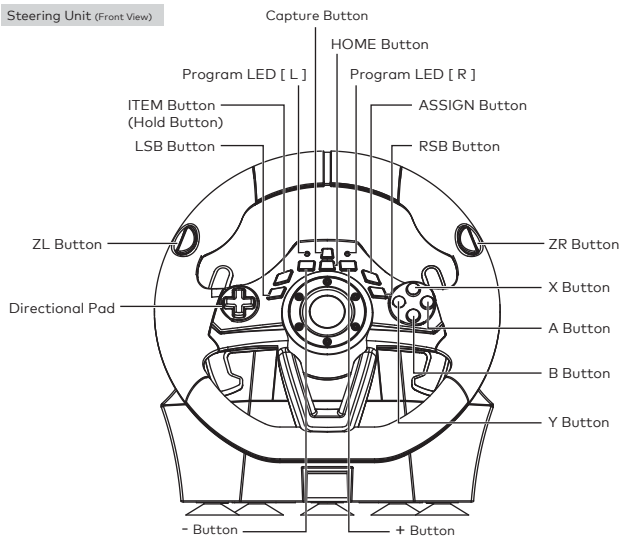

Steering Unit (Back View)

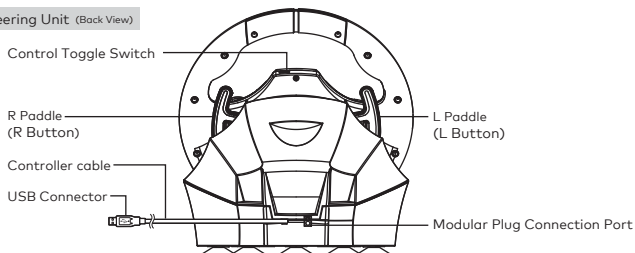

Foot Pedals

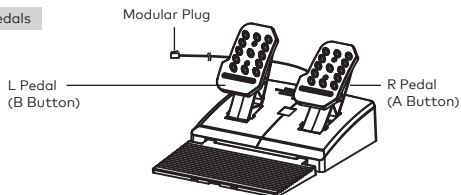

■ How to Mount

Steering Unit

Option 1: Suction Cup

- ① Remove all dust and dirt from your tabletop before securing the controller using the five suction cups.
- ② Attach suction cups to steering unit when setting up.



- Do not combine both securing methods as it may damage the suction cups.
- Do not affix to furniture made from glass or other fragile materials.
- Detach from furniture carefully to prevent damage to furniture or product.

Option 2: Clamp

- ① Tighten the clamp screw into the steering wheel base.
- ② Use the clamp to secure the steering unit to a flat, hard surface (i.e. table).



Foot Pedals

Place foot pedals onto a flat surface.



■ Control Toggle Switch

Directional pad controls can be toggled to directional pad, left stick or right stick controls.

This product's directional pad toggle function is not guaranteed to work with all software.

- Please refer to software's instruction book. This product does not work with Analog mode.



Directional pad



Left stick



Right stick

■ Button Hold function

Push and hold the Hold button to maintain the pushed state after releasing your finger.

How to Enable

Press for 1 second



Red LED turns on.

How to Disable

Press Once



Red LED turns off.

ZL button / ITEM button / L Paddle

Button Hold function works only when ITEM button has ITEM function.

CAUTION When playing Mario Kart

While the Button Hold function is enabled: If you want to use the item you pick up, press any of the ZL button / ITEM button / L Paddle once to disable the Button Hold function. Then press the button again to use the item.

■ Assign Mode

You can remap the function of buttons using this feature.

Programmable Buttons

ZL / ZR / LSB / RSB / ITEM / L Paddle / R Paddle / L Pedal / R Pedal

Assignable Functions

A / B / X / Y / L / R / ZL / ZR / LSB / RSB / ITEM / L Paddle / R Paddle
Directional Pad (Right / Down / Left / Up) / Left stick (Right / Down / Left / Up) / Right stick (Right / Down / Left / Up)

How to Adjust

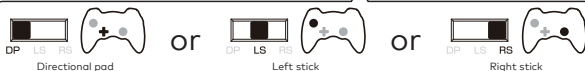
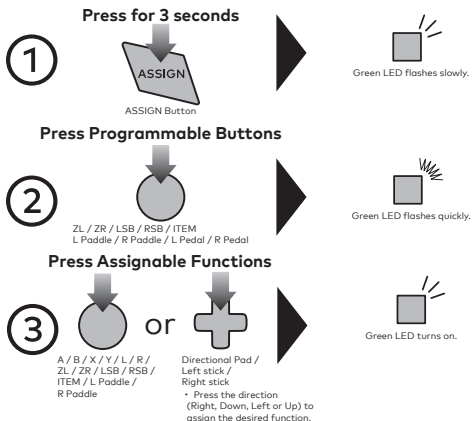

- After 4 seconds of inactivity between steps, Program LED (Right) will turn off and program mode will stop.
- During steps 2, button input from the controller to the Nintendo Switch™ will be disabled.
- When the Program LED (Left) turns on, it indicates that a button is remapped and will not turn off until button function is reset to default.
- If you want to disable button function, press and hold for 3 seconds the same button you pressed in step 2 at the time of step 3.
- If you pressed multiple buttons during step 3, the last button you pressed will be assigned.
- Controller settings are stored even if the USB is disconnected.

How to reset individual buttons

Use the Step 3 above to individually reset buttons to default.

How to reset all buttons / functions to default

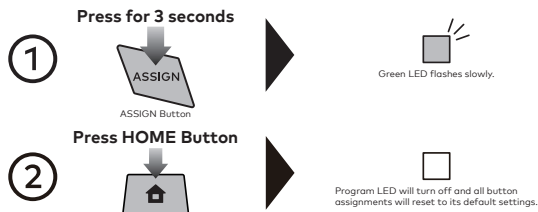

■ Quick Handling Mode

Experience quicker handling by switching the max steering output from 270 degrees to 180 degrees.

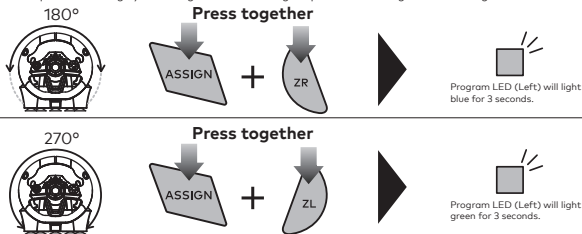

■ Adjustable Sensitivity

Steering wheel sensitivity is adjustable to seven levels.
The Program LED (Left) colour will change to indicate the sensitivity value.

Steering Unit

Press for 3 seconds

①

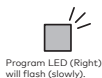

②

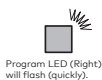

Set Control Toggle Switch to LS

③

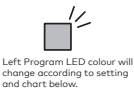

Press

④



Sensitivity value increases by pressing up on the Directional Pad.

Responsive

⑤



Sensitivity value decreases by pressing down on the Directional Pad.

Gradual

⑥

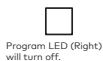

(The Program LED (Right) will light green when assigning buttons.)

- If you do not perform step ③ after ①, the Program LED (Right) will turn off after four seconds and button assignment mode will automatically end.
- During steps 2~6, only the steering unit and foot pedal input are enabled.
Button input from the controller to the Nintendo Switch™ will be disabled.
- Controller settings are stored even if the USB is disconnected.

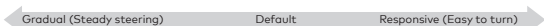

	1	2	3	4	5	6	7
LED colour	Green	Yellow	Red	Purple	Blue	Light Blue	White

■ Adjustable Dead Zone

The Dead Zone is adjustable to seven levels.

Program LED (Left) colour will change to indicate the dead zone value.

Press for 3 seconds

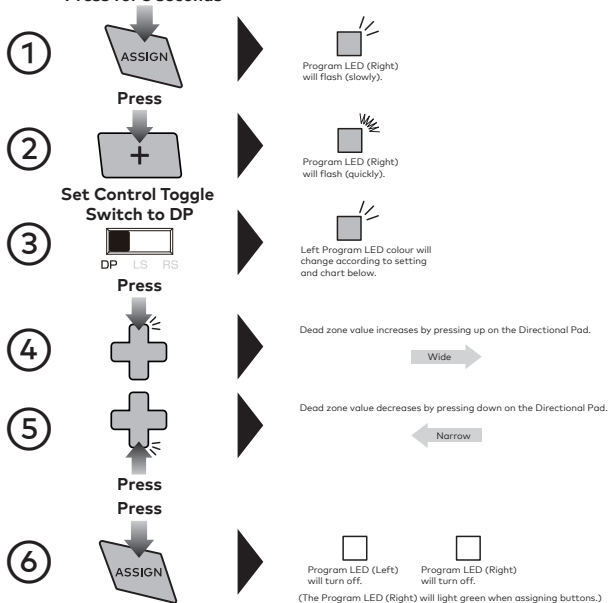

- If you do not perform step ③ after ①, the Program LED (Right) will turn off after four seconds and button assignment mode will automatically end.
- During steps 2~6, only the steering unit and foot pedal input are enabled.
Button input from the controller to the Nintendo Switch™ will be disabled.
- Controller settings are stored even if the USB is disconnected.



	1	2	3	4	5	6	7
LED	Green	Yellow	Red	Purple	Blue	Light Blue	White

■ Reset back to default settings

To simultaneously reset all of the following: Quick Handling Mode • Dead Zone Adjustment • Sensitivity Adjustment.

Press for 3 seconds

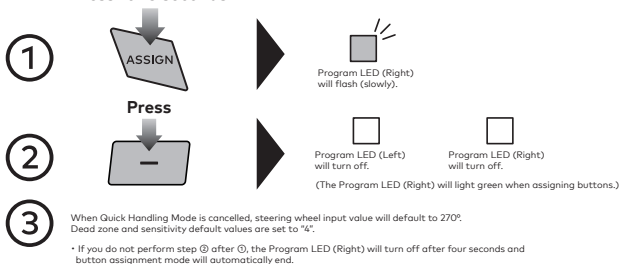

■ Caution

- Never disassemble, repair, or modify this product.
- Keep the controller away from dusty or humid areas.
- Do not apply strong impact or weight on the product.
- Do not pull roughly or bend the cable of the controller.
- If product needs cleaning, use only a soft dry cloth. Do not use any chemical agents like benzene or thinner.
- Keep this product out of the reach of children under 3.

■ Main Specifications

Steering Unit

External Dimensions : 280 × 275 × 286mm

Steering Diameter : 280mm

Weight : 1400g

Angle of Rotation : 270°

Cable Length : 3m

Foot Pedals

External Dimensions : 234 × 305 × 180mm

Weight : 700g

Cable Length : 1.5m

THE FCC WANTS YOU TO KNOW

This device complies with part 15 of the FCC Rules. Operation is subject to the following two conditions:

(1) This device may not cause harmful interference, and (2) this device must accept any interference received, including interference that may cause undesired operation.

THE FCC WANTS YOU TO KNOW

This equipment has been tested and found to comply with the limits for a Class B digital device, pursuant to Part 15 of the FCC Rules. These limits are designed to provide reasonable protection against harmful interference in a residential installation.

This equipment generates, uses and can radiate radio frequency energy and, if not installed and used in accordance with the instructions, may cause harmful interference to radio communications.

However, there is no guarantee that interference will not occur in a particular installation.

If this equipment does cause harmful interference to radio or television reception, which can be determined by turning the equipment off and on, the user is encouraged to try to correct the interference by one or more of the following measures:

- Reorient or relocate the receiving antenna.
- Increase the separation between the equipment and receiver.

PRODUCT DISPOSAL INFORMATION

Where you see this symbol on any of our electrical products or packaging, it indicates that the relevant electrical product or battery should not be disposed of as general household waste in Europe. To ensure the correct waste treatment of the product and battery, please dispose of them in accordance with any applicable local laws or requirements for disposal of electrical equipment or batteries. In so doing, you will help to conserve natural resources and improve standards of environmental protection in treatment and disposal of electrical waste.



Applicable to EU countries and Turkey only.

EU and Turkey only

Simplified Declaration of Conformity

Hereby, HORI declares that this product is in compliance with Directive 2014/53/EU.

The full text of the EU declaration of conformity is available at the following internet address:

<https://hori.co.uk/consumer-information/>

For UK: Hereby, HORI declares that this product is in compliance with the relevant statutory requirements.

The full text of the declaration of conformity is available at the following internet address:

<https://hori.co.uk/consumer-information/>

US

Warranty

HORI warrants to the original purchaser that the product purchased new in its original packaging shall be free of any defects in material and workmanship for a period of 90 days from the original date of purchase. If the warranty claim cannot be processed through the original retailer please contact HORI customer support directly at infous@hori.jp.

Please visit <http://stores.horiusa.com/policies/> for warranty details.

EU

Warranty

For all warranty claims made within the first 30 days after purchase, please check with the retailer where the original purchase was made for details. If the warranty claim cannot be processed through the original retailer or for any other inquiries pertaining to our products, please contact HORI customer support directly at infous@hori.jp.

To contact AIC, the official representative of HORI in KSA, please contact us via email or phone.

Email: info@aic.com.sa

Phone number: 8001010029

For more details, you may visit HORI in KSA website: hori.aic.com.sa

Warning, Not suitable for children under 36 months, Long cord, Strangulation hazard.

The image on the package may differ from the actual product.

The manufacturer reserves the right to change the product design or specifications without notice.

The wires are not to be inserted into socket-outlets.

The packaging must be retained since it contains important information.

HORI & HORI logo are registered trademarks of HORI.



MADE IN CHINA